



**Read all instructions before using or installing the product. Keep for future reference. Include the user manual when passing the product on to third parties.**

- The product is designed to dim RGBW LED strip lights.
- The product works with the remote control LMZA4536 or with a Zigbee hub
- Input voltage: 24 V DC
- Output current: 3.5 A max.
- Max. output power: 84 W
- Output Type: Constant voltage
- Transmission frequency: 2.4 GHz
- Transmission line: 6 dbm
- Protection rating: IP20 (Do not expose to moisture)
- Compatible drivers (power supply):  
OTNA4372 DRIVER 30W DC 24V,  
OTNA4373 DRIVER 60W DC 24V,  
OTNA4374 DRIVER 120W DC 24V
- Usage note: The power of the connected LED strip light cannot be bigger than the max. output of the controller (84 W) nor bigger than the power of the chosen driver (power supply). It is possible to choose a smaller 30 W driver if the power of the strip light is not bigger than 30 W.

## Product introduction

Max. input: 24 V DC, 3.5 A

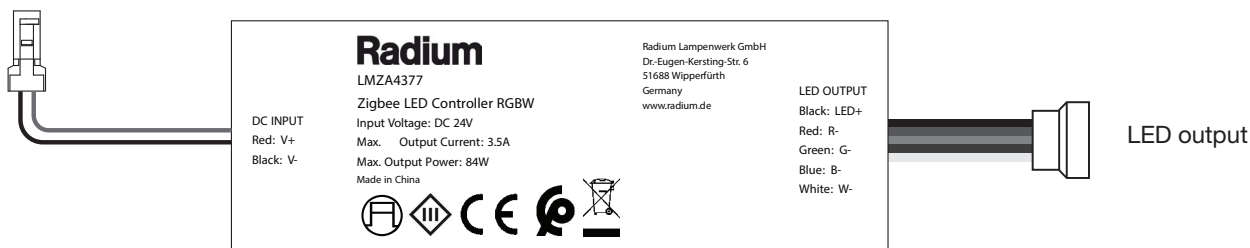

## Pairing the product to a remote control without using a ZigBee hub

The following instructions are based on the assumption that the controller has already been connected to a driver and a strip light.

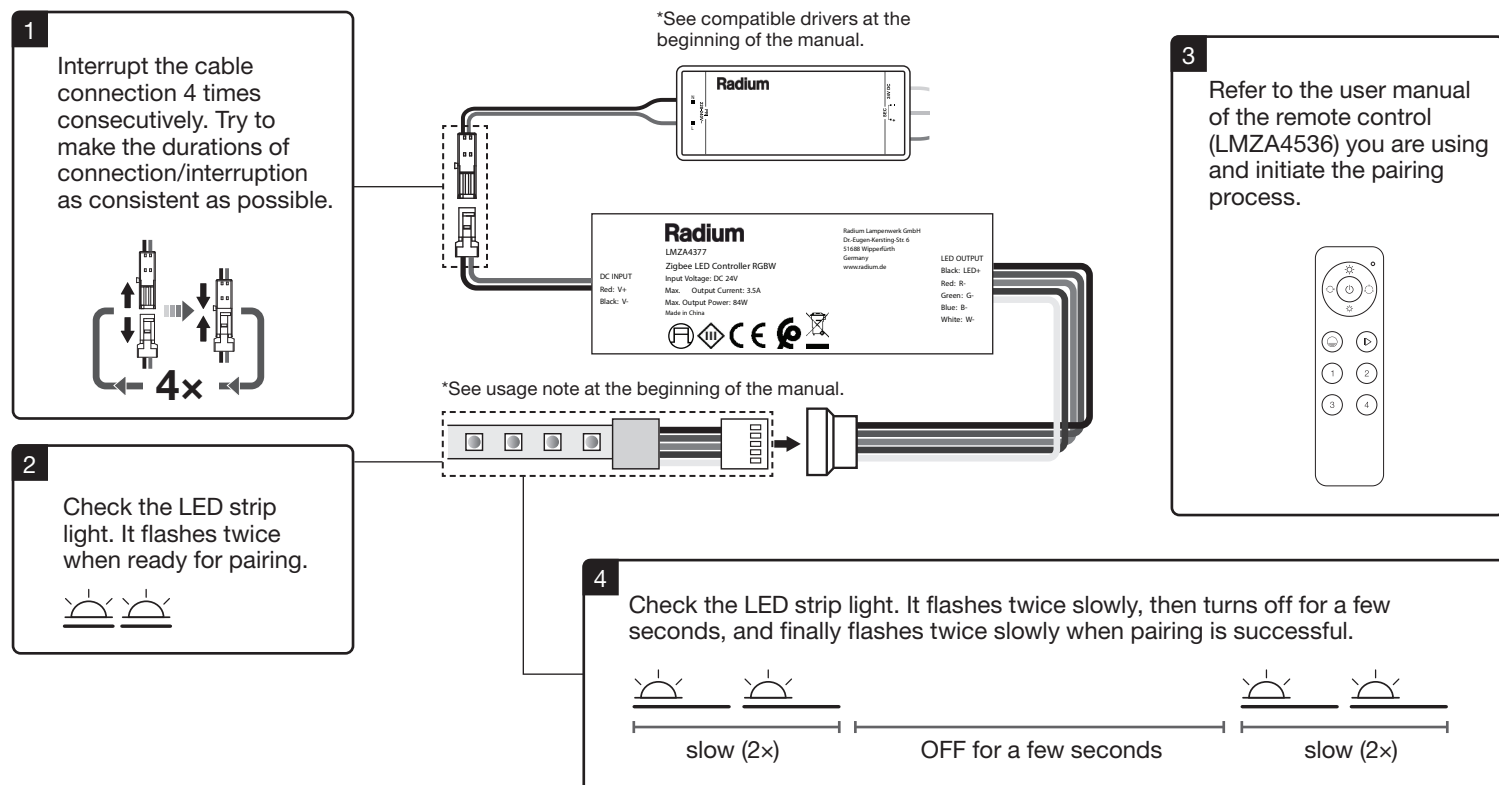

## Pairing the product to a ZigBee hub

The following instructions are based on the assumption that the controller has already been connected to a driver and a strip light.

1

Start device search on ZigBee hub.



2

Follow the steps in the chapter "Resetting the product" to reset the product and initiate the pairing mode.

3

Check the LED strip light. It flashes 6 times quickly and then twice slowly when pairing is successful.

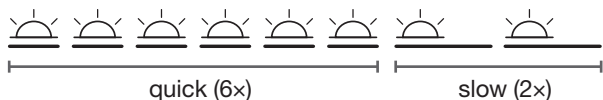

4

If you want to use a remote control in parallel with the ZigBee hub, refer to the user manual of the remote control to pair it with the hub as well.

\*See compatible drivers at the beginning of the manual.

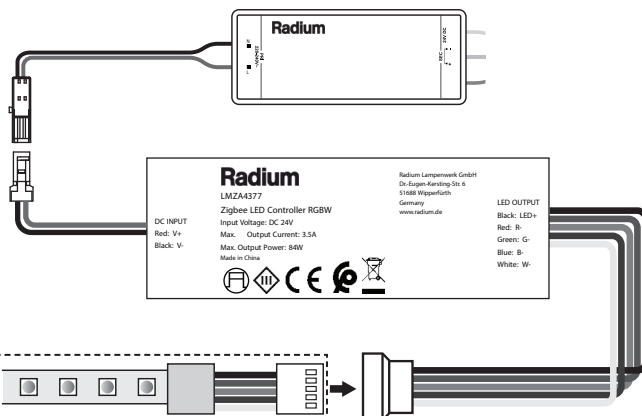

\*See usage note at the beginning of the manual.

## Resetting the product

The product will be reset to factory defaults with all user's settings deleted. The following instructions are based on the assumption that the controller has already been connected to a driver and a strip light.

1

Interrupt the cable connection 5 times consecutively. Try to make the durations of connection/interruption as consistent as possible.

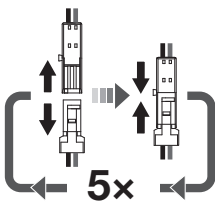

2

Check the LED strip light. It flashes 3 times when reset is done. The product is ready for pairing.



\*See compatible drivers at the beginning of the manual.

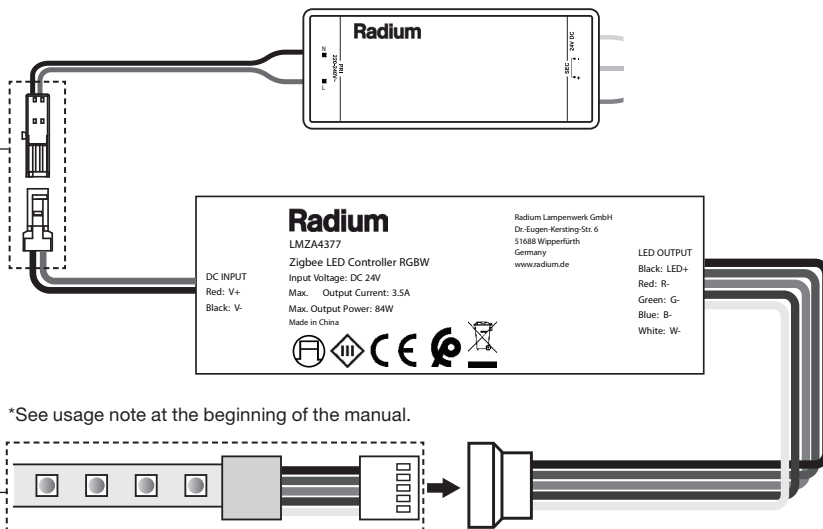

\*See usage note at the beginning of the manual.

### SIMPLIFIED EU DECLARATION OF CONFORMITY

Hereby, Radium Lampenwerk GmbH declares that the radio equipment type LMZA4377 Controller ZGB RGBW 84W/24V IP20 is in compliance with Directive 2014/53/EU.

The full text of the EU declaration of conformity is available at the following internet address: <https://www.radium.de/LMZA4377>



Old appliances must not be disposed of with residual waste. They can be handed in at public collection points run by waste disposal companies. Used batteries and lamps that can be removed from the old appliance without causing damage must be separated from the old appliance before being handed in to a collection point. Distributors are obliged to take back this product free of charge in accordance with Section 17 (1) and (2) of the German Electrical and Electronic Equipment Act. End users of waste equipment are responsible for deleting personal data from the waste equipment.

Radium Lampenwerk GmbH  
Dr.-Eugen-Kersting-Straße 6  
51688 Wipperfurth  
GERMANY

[www.radium.de](http://www.radium.de)



Scan for  
more  
product  
information.